

Frameless
Flush
Shadowgap
Solutions

AGSsystems

By
THEINVISIBLETOOLBOX.ca
SOUND PRINCIPLES FOR MINIMAL CONSTRUCTION

Concealed door frames for stud and block walls



For service in Canada
please visit:



THEINVISIBLETOOLBOX.ca

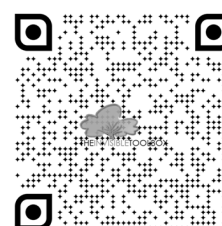
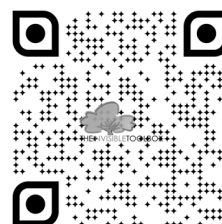
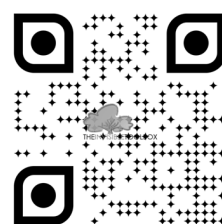

architrave-free design
for a more contemporary look

AGSsystems



**Solution at highest level
for design lovers**



Every door is special
individual, unique, elegant
the door as a design element

No more gap-filling sealants

Architrave-free doorways are an important feature of modern building design, to give rooms a more spacious and uncluttered look. But a door is a moving part of the building, and architraves were designed to conceal the vibration cracks around the door frame.

AGS has overcome this problem for concealed door frames with an integral plastering reinforcement mesh, that bonds the frame to the wall in a permanent way. No cracks, no frame sealants!

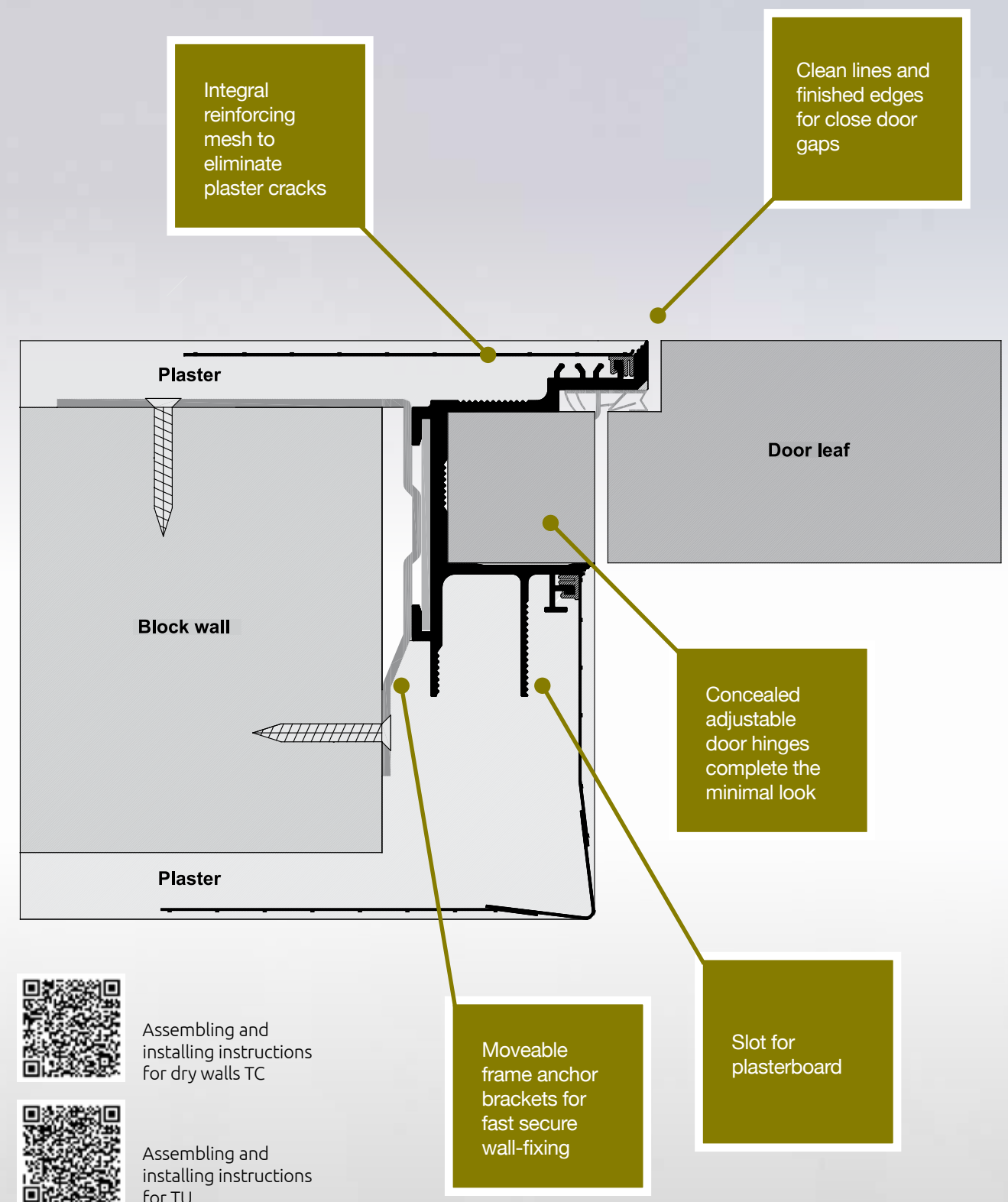

Exclusivity and modern design solution
in our focus

Frame production according to the customers requirements

Doorframes
for stud and block walls

Concealed frame
for outward opening doors

TUT TYPE
for 44 to 65 mm door leaves

For maximum flexibility, 30 min tested by Chiltern Fire. The frame profiles are supplied either mitre-cut to size, or loose for cutting and assembly on-site. They are assembled using locking mitre corner inserts, temporary corner braces and bottom spreader bar. The frame is then inserted to one side of the opening, attached using moveable brackets. The snap-in mesh ensures no plaster cracks between wall and frame. The door is hung from concealed adjustable hinges set into full-length hardwood sections inserted on all 3 sides of the frame. Suits standard or floor-to-ceiling doors.

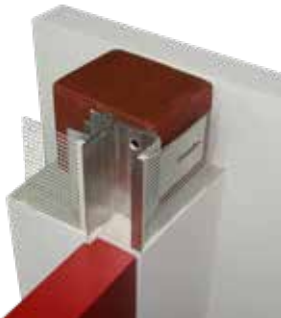
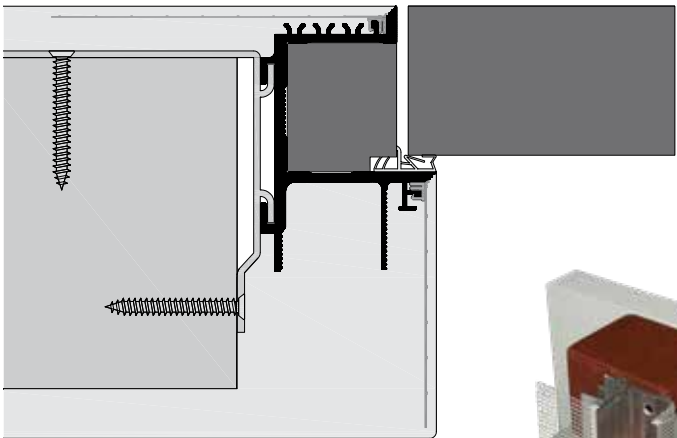

Concealed frame
for outward opening doors

TCT TYPE
for 44/45 mm and 50 mm door leaves

The frame profiles are supplied mitre-cut to suit door size, and machined to suit concealed hinges, lock strikes and other hardware. They are assembled using locking mitre corner inserts, SnapIN corner connectors and bottom spreader bar. The frame is then inserted to one side of the opening, attached using moveable brackets. The snap-in mesh ensures no plaster cracks between wall and frame. The door is hung from concealed adjustable hinges set into the frame. Suits standard or floor-to-ceiling doors.

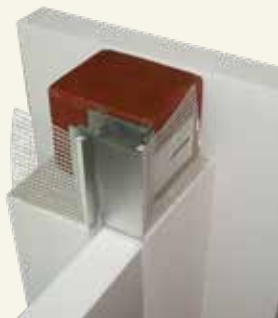
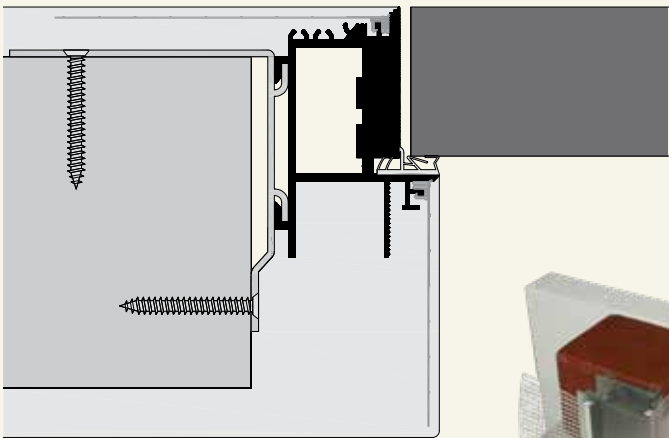

Concealed frame
for inward opening doors

TUS TYPE
for 44 to 59 mm door leaves

For maximum flexibility, 30 min tested by Chiltern Fire. The frame profiles are supplied either mitre-cut to size, or loose for cutting and assembly on-site. They are assembled using locking mitre corner inserts, temporary corner braces and bottom spreader bar. The frame is then inserted to one side of the opening, attached using moveable brackets. The snap-in mesh ensures no plaster cracks between wall and frame. The rebated door is hung from concealed adjustable hinges set into a full-length hardwood sections inserted on all 3 sides of the frame. Suits standard or floor-to-ceiling doors.

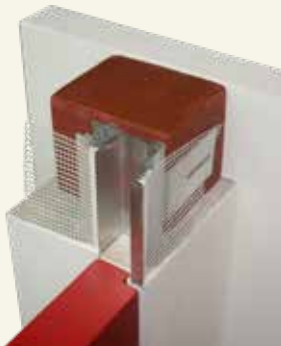
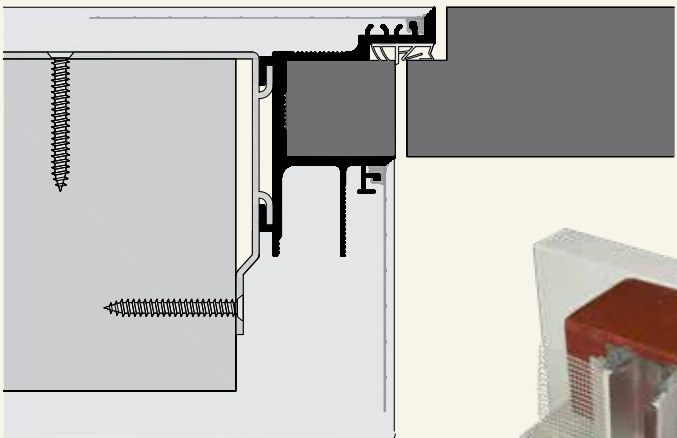

Concealed frame
for inward opening doors

TCS TYPE
for 44/45 and 50 mm door leaves

The frame profiles are supplied mitre-cut to suit door size, and machined to suit concealed hinges, lock strikes and other hardware. They are assembled using locking mitre corner inserts, SnapIN corner connectors and bottom spreader bar. The frame is then inserted to one side of the opening, attached using moveable brackets. The snap-in mesh ensures no plaster cracks between wall and frame. The rebated door is hung from concealed adjustable hinges set into the frame. Suits standard or floor-to-ceiling doors.

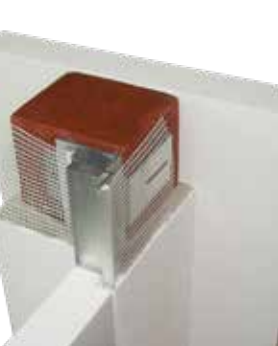
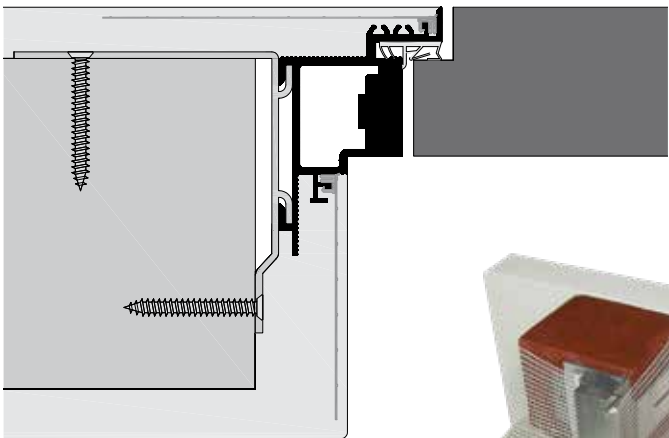

Concealed frame
for inward/outward opening doors

TST TYPE
for 40 and 44 mm door leaves

The frame profiles are supplied mitre-cut to suit door size, and machined to suit concealed hinges, lock strikes and other hardware. They are assembled using locking mitre corner inserts, SnapIN corner connectors and bottom spreader bar. The frame is then inserted to one side of the opening, attached using moveable brackets. The snap-in mesh ensures no cracks appear between wall and frame. The door is hung from concealed adjustable hinges set into the frame. Suits standard or floor-to-ceiling doors.

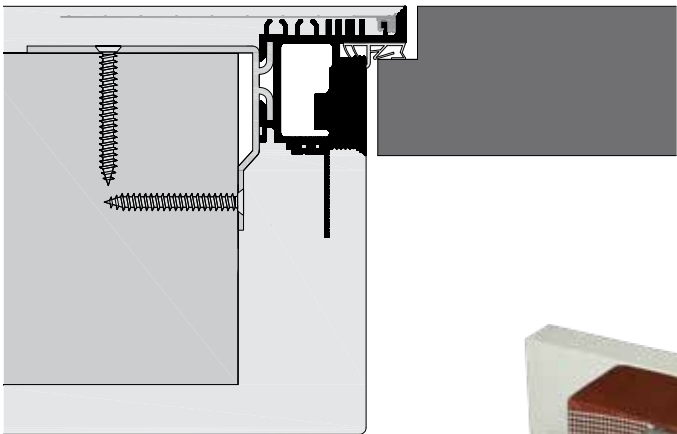

Concealed frame
for inward opening doors
without recess

TCS50F TYPE
for 50 mm door leaves

The frame profiles are supplied mitre-cut to suit door size, and machined to suit concealed hinges, lock strikes and other hardware. They are assembled using locking mitre corner inserts, SnapIN corner connectors and bottom spreader bar. The frame is then inserted to one side of the opening, attached using moveable brackets. The snap-in mesh ensures no plaster cracks between wall and frame. The rebated door is hung from concealed adjustable hinges set into the frame. Suits standard or floor-to-ceiling doors.

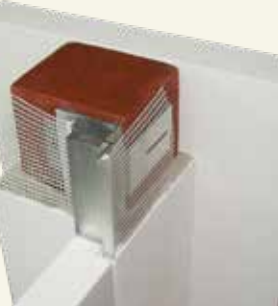
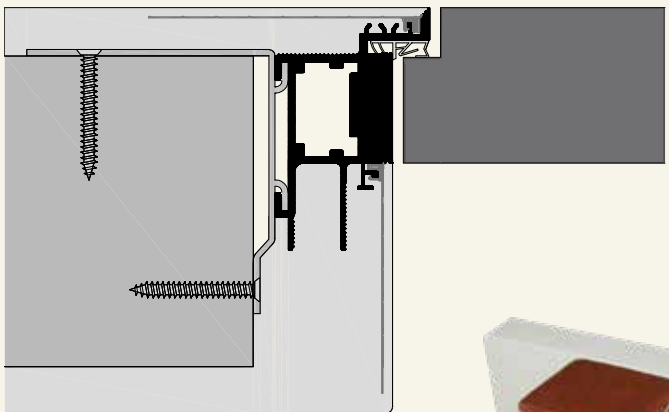

Shadow gap profile system
for inward/outward opening
timber door frames

TL TYPE
for 40 to 60 mm door leaves

This profile system is push-fitted onto grooves in the frame linings prior to installing a finished timber door frame, to create the perfect shadow gap outline, and eliminate the need for architraves. The snap-in mesh ensures no plaster cracks between wall and frame. Suits standard or floor-to-ceiling doors.

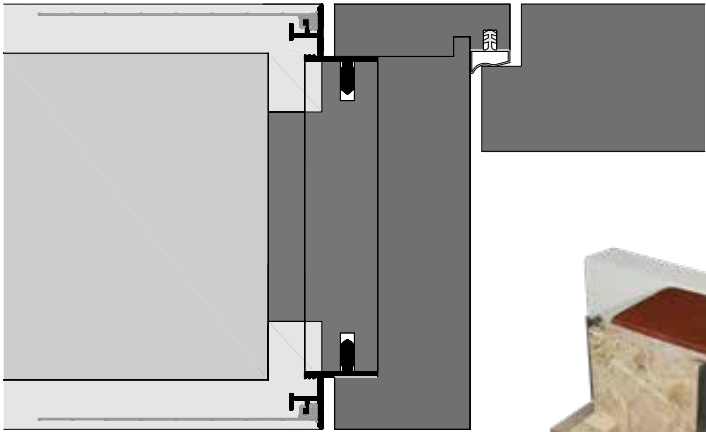

Shadow gap profile system
for inward/outward opening
timber door frames

TFN TYPE
for 40 to 60 mm door leaves

This profile system is fitted to the frame linings prior to installing a finished timber door frame, to create the perfect shadow gap outline, and eliminate the need for architraves. The snap-in mesh ensures no plaster cracks between wall and frame. Suits standard or floor-to-ceiling doors.

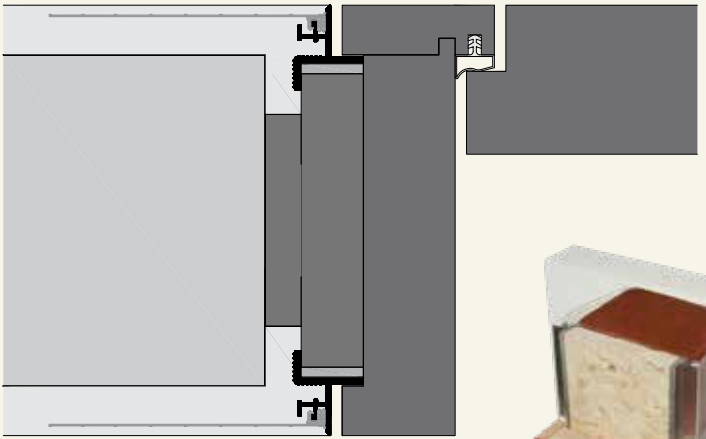

Concealed sub-frame
for outward opening
timber door frames

TPL TYPE
for 40 to 65 mm door leaves

The sub-frame profiles are supplied either mitre-cut to size, or loose for cutting and assembly onsite. They are assembled using locking mitre corner inserts, temporary corner braces and bottom spreader bar. The frame is then inserted to one side of the opening, attached using moveable brackets. The snap-in mesh ensures no plaster cracks between wall and frame. The timber frame and door is hung from the sub-frame. Suits standard or floor-to-ceiling doors.

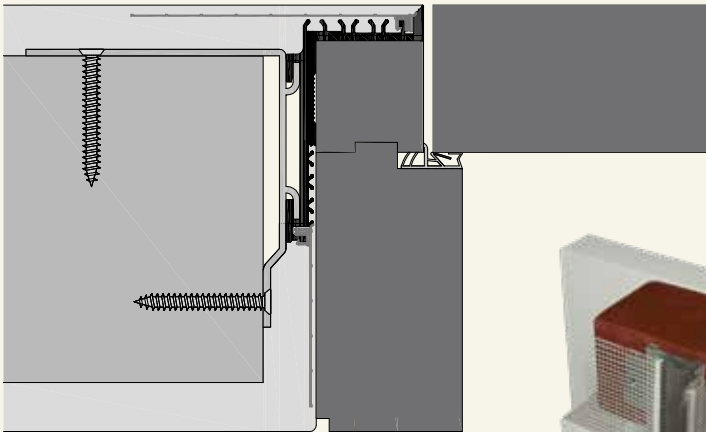

Concealed sub-frame
for inward/outward opening
timber-framed doors with
shadow gap

TP TYPE
for 44 to 60 mm door leaves

The sub-frame profiles are supplied either mitre-cut to size, or loose for cutting and assembly onsite. They are assembled using locking mitre corner inserts, temporary corner braces and bottom spreader bar. The frame is then inserted to one side of the opening, attached using moveable brackets. The snap-in mesh ensures no plaster cracks between wall and frame. The timber frame and door is hung from the sub-frame, creating a shadow gap. Suits standard or floor-to-ceiling doors.

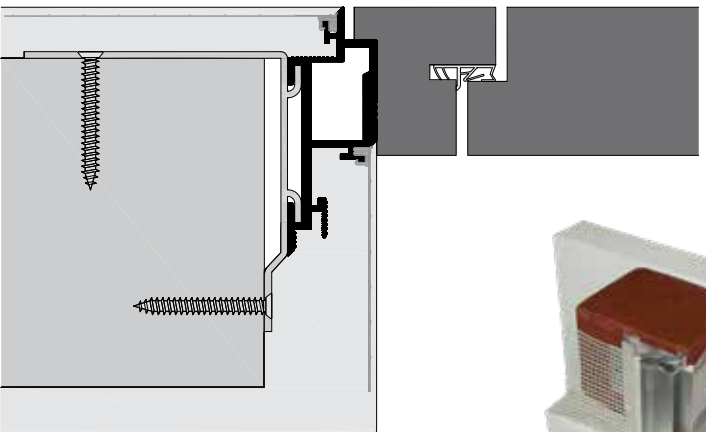

Concealed sub-frame
for inward opening
timber door frames

TPS TYPE
for 40 to 65 mm door leaves

The sub-frame profiles are supplied either mitre-cut to size, or loose for cutting and assembly on-site. They are assembled using locking mitre corner inserts, temporary corner braces and bottom spreader bar. The frame is then inserted to one side of the opening, attached using moveable brackets. The snap-in mesh ensures no plaster cracks between wall and frame. The timber frame and door is hung from the sub-frame. Suits standard or floor-to-ceiling doors.

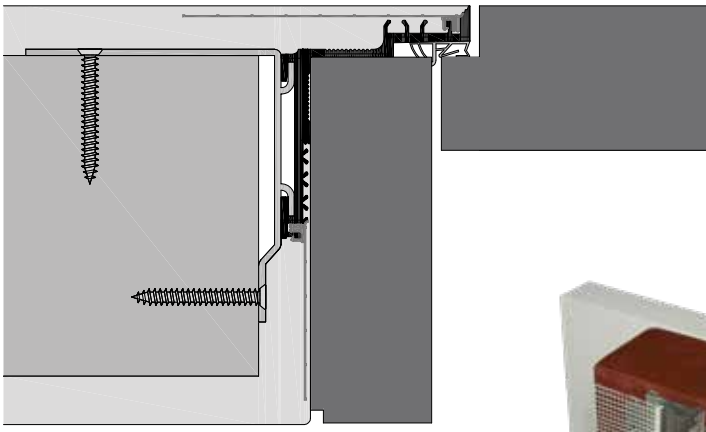

Concealed frame
for glass doors

TCG TYPE
for glass doors of 8 and 10 mm

Specially invented for all-glass doors of 8 and 10 mm. The frame profiles are supplied mitre-cut to suit door size, and machined to suit concealed hinges, lock strikes and other hardware. They are assembled using locking mitre corner inserts, SnapIN corner connectors and bottom spreader bar. The frame is then inserted to one side of the opening, attached using moveable brackets. The snap-in mesh ensures no plaster cracks between wall and frame. The door is hung from concealed adjustable hinges set into the frame. Suits standard or floor-to-ceiling doors.

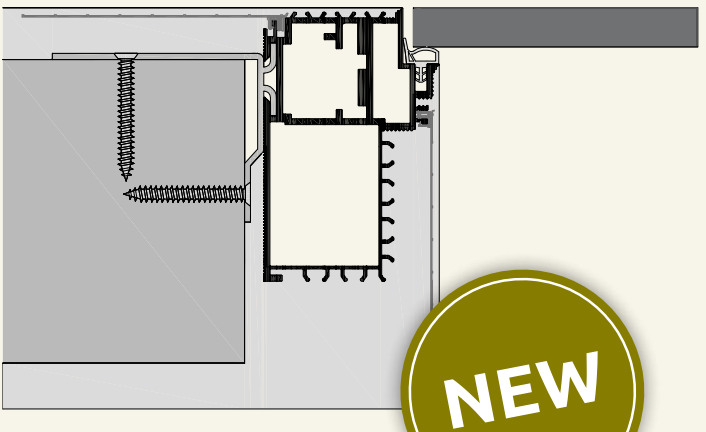



Wall-flush skirting boards

for a uniforme appearance

More infos provided on www.ag-sys-tem-s.com



PRODUCT RANGE

Concealed aluminium door frame type TUS
including protective film and mesh support for door leaves of 44/45, 50, 56 and 59 mm - standard profile length 1100, 2200, 2750, 3300 mm

Description	Item no.
TUS45	10445
TUS50	10450
TUS56	10456
TUS59	10459

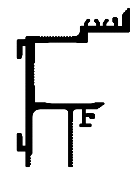

Concealed aluminium door frame type TUT
including protective film and mesh support for door leaves of 44/45, 50, 56 and 59 mm - standard profile length 1100, 2200, 2750, 3300 mm

Description	Item no.
TUT45	10345
TUT59	10359

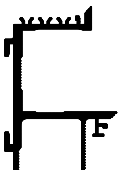

Concealed aluminium door frame type TCS
including protective film and mesh support for door leaves of 44/45 and 50 mm maximum door height 3000 mm

Description	Item no.
TCS45	10645
TCS50	10650
TCS50F	10660

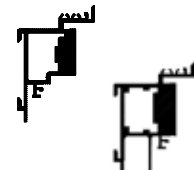

Concealed aluminium door frame type TCT
including protective film and mesh support for door leaves of 44/45 and 50 mm maximum door height 3000 mm

Description	Item no.
TCT45	10545

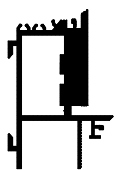

Concealed aluminium door frame type TST
including protective film and mesh support for door leaves of 40 and 44 mm maximum door height 3000 mm

Description	Item no.
TST40	10740
TST45	10130

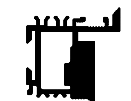

Concealed aluminium door frame type TCG
including protective film and mesh support for glass doors of 8 mm maximum door height 3000 mm

Description	Item no.
TCG	10160

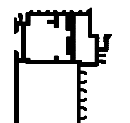

Aluminium sub-frame type TPL
including protective film and mesh support for door leaves of 40 to 65 mm - standard profile length 1100, 2200, 2750, 3300 mm

Description	Item no.
TPL	10150

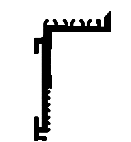

Aluminium sub-frame type TPS
including protective film and mesh support for door leaves of 40 to 65 mm - standard profile length 1100, 2200, 2750, 3300 mm

Description	Item no.
TPS	10140

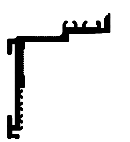

Aluminium sub-frame type TP
including protective film and mesh support for door leaves of 44 to 60 mm - standard profile length 1100, 2200, 2750, 3300 mm

Description	Item no.
TP	10121

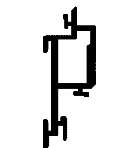

Aluminum shadow gap frame type TFN
including protective film and mesh support for door leaves of 40 to 60 mm - standard profile length 1100, 2200, 2750, 3300 mm

Description	Item no.
TFN	10115

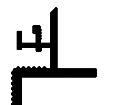

Aluminum shadow gap frame type TL
including protective film and mesh support for door leaves of 40 to 60 mm - standard profile length 1100, 2200, 2750, 3300 mm

Description	Item no.
TL	10110

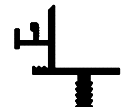

Bottom spreader bar set (distance spacer)

Description	Item no.
TUT, TUS, TCT, TCS, TP, TPL, TPS	13013
TST, TCG	13053



PVC mesh
suitable for all door frames of AGS systems length 2300 mm packaging unit 30 pcs

Item no.
13042

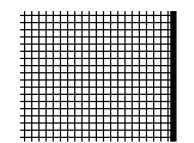

Wall fixing bracket wall thickness < 100

Description	Item no.
TUT, TUS, TCT, TCS, TP, TPL, TPS	13010R100



Corner connector set

Description	Item no.
TUT, TUS, TP, TPL, TPS	13011



KIT corner connectors SnapIN

Description	Item no.
TST	13056
TCT, TCS, TCG	13058



Double-sided adhesive tape
3 mm for TFN profile, coil of 5,50 m

Item no.
50050



Wall fixing bracket wall thickness 100

Description	Item no.
TUT, TUS, TCT, TCS, TP, TPL, TPS	13010 A
TST40	13055
TST45, TCG	13052



Door seal

Description	Item no.
TUT, TUS, TCT, TCS, TP, TPL, TPS, TL, TFN	50096S
black 5,50 m	50097S
black 6,60 m	50096W
white 5,50 m	50097W
TCG	
white 15,00 m	50095

*Excess lengths on request



> Minimal > Aesthetic > Hygienic > Functional > Easy to assemble

More information, sectional drawings as
DWG or PDF file are available on our website
www.ags-systems.com

AGS-SYSTEMS SRL

Stava 47/B | I-39025 Naturno (BZ)
Ph. +39 0473 666376
Fax +39 0473 420390
info@ags-systems.com
www.ags-systems.com

Trading partner:

THEINVISIBLETOOLBOX.CA

Ph:647.500.4103.

INFO@THEINVISIBLETOOLBOX.CA

36 ALBERTA AVE, TORONTO. ONTARIO.CANADA
M6H-2R6

